

MF23BSET

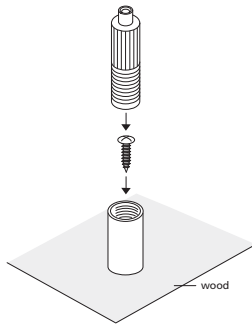

°MF23BSET

MF23 is a floor tensioner that also works well as a turnbuckle for balustrades. Use it to tension cables to minimize the movement of displays

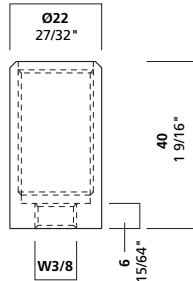
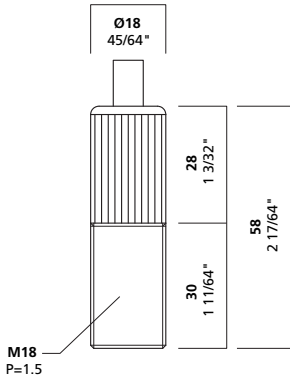

° Product Information

cable size

1/8" 3.0 mm

maximum weight

220 lbs. 100 kg

function

tensioner: floor

MF23BSET: surface mount: concrete, wood, tile

installation instructions

MF23: Thread tensioner into socket two turns. Insert cable. Turn tensioner down by HAND.

MF23BSET: Attach socket to wood floor with 1/4" screw. Attach to concrete floor with 3/8-16 anchor. Bolt or screw socket to floor. Adjust ceiling connector so cable is 1 1/4 inch from the floor. Thread tensioner into socket two turns. Insert cable. Turn tensioner down by HAND.

4

Arakawa Hanging Systems

2505 SE 11th Avenue, Suite 122

Portland, Oregon 97202

phone: 503.236.0440

fax: 503.236.0427

toll free: 888.272.5292

www.arakawagrip.com



Copyright © 2007 Arakawa & Co., Ltd. All rights reserved. Arakawa products are covered by U.S. and foreign patents, issued and pending. Specification and price change privileges reserved.