

MF16S



°MF16S

MF16S incorporates the familiar bullet shaped body with a 3/8-16 female thread, permitting installations into concrete ceilings (using 3/8-16 stud and drop-in expansion anchor). May also be used as a midway support for a hang rod.

° Product Information

cable size
1/8"

maximum weight
1/8" 220 lbs 100 kg

function
ceiling: wood, concrete
midway: shelf, rod support

installation instructions
With 3/8-16 threaded stud and matching concrete anchor, thread the MF16S onto the stud and then into the anchor. As a midway support drill 5/8" diameter hole in hang rod. Maximum diameter of hang rod is 1 5/8".

4

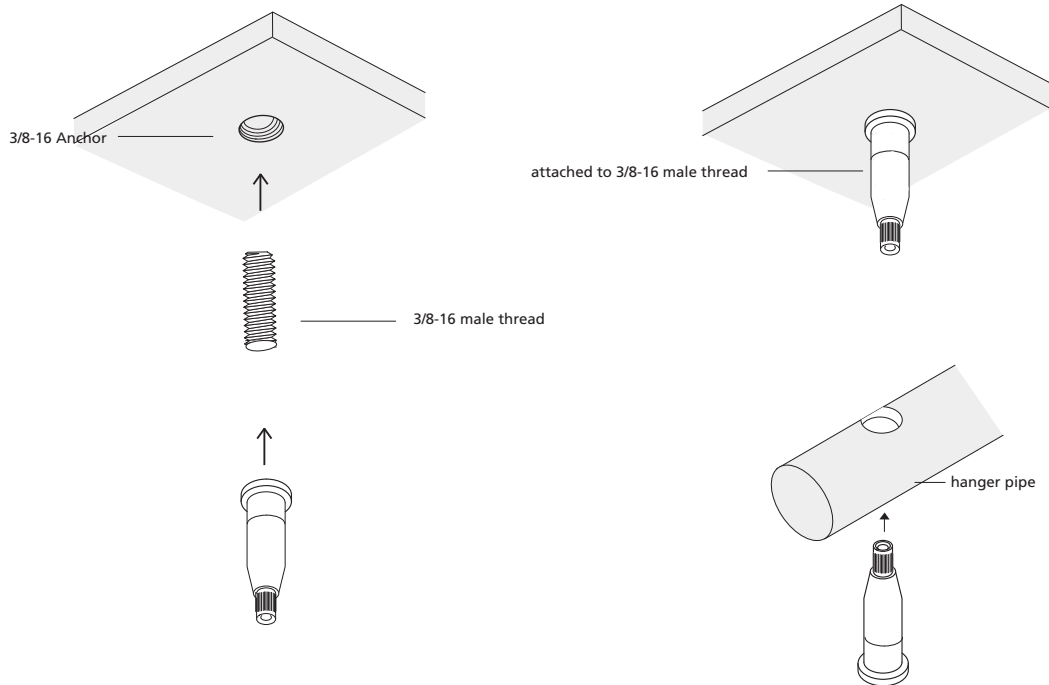

Arakawa Hanging Systems
2505 SE 11th Avenue, Suite 122
Portland, Oregon 97202
phone: 503.236.0440
fax: 503.236.0427
toll free: 888.272.5292

www.arakawagrip.com



Copyright © 2008 Arakawa & Co., Ltd. All rights reserved.
Arakawa products are covered by U.S. and foreign patents, issued and pending. Specification and price change privileges reserved.