

# HJHD

2-3

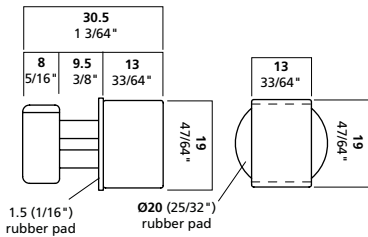

## Cable Size

1/16": 1.5 mm  
3/32": 2.5 mm

## Maximum Weight

1/16": 65 lbs    30 kg  
3/32": 155 lbs    70 kg

## Function

rail fitting: VH4

## Description

HJHD is a fixed rail fitting for VH4 rail that uses ball-stopped cable instead of an internal gripping mechanism.

## Installation

Insert ball-stopped cable into HJHD from the top of the fitting. Position HJHD at any desired location along the open U-channel of VH4 rail, insert HJHD into rail at a 90 degree angle (bottom end of cable facing right), then twist 90 degrees clockwise to properly align.

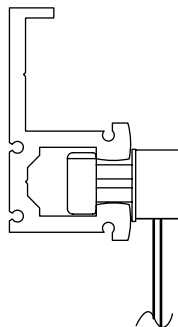

# Arakawa

HANGING SYSTEMS

Arakawa Hanging Systems, Inc.

2505 SE 11th Ave, Suite 122

Portland, OR 97202

phone: 503.236.0440

fax: 503.236.0427

toll free: 888.272.5292

[www.arakawagrip.com](http://www.arakawagrip.com)