

# EW-Type



◦ EW2



◦ EW3 (shown with SF23)



◦ EW4 (shown with SF23)

EW-type tensioners are intended for use (with the SF23 tensioner) where a permanent attachment to the floor is not desired or possible.

They allow for quick and easy installation, reposition and removal or cable hung artwork and photos, signage and graphics, shelves, privacy screens and/or room dividers.

EW2, EW3 and EW4 have a height of 4 11/16", base diameter of 2 5/16", and a weight of approximately 6.5 pounds (3 kg). EW2 is raw mild steel, and will rust over time (oil the threaded parts to ensure SF23BO can continue to function). EW3 is chrome plated, and EW4 is powdercoated light gray.

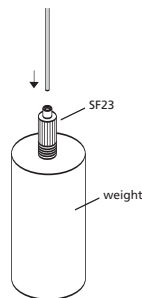
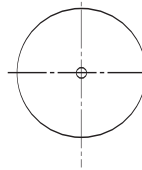
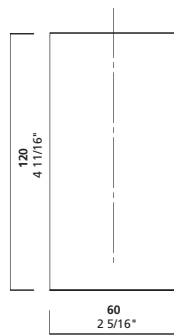

## ◦ Product Information

### cable size

1/16" 1.5 mm  
3/32" 2.5 mm

### maximum weight

1/16": 65 lbs. 30 kg  
3/32": 155 lbs. 70 kg

### function

tensioner: floor

### types

**EW2** - raw mild steel  
**EW3** - chrome plated  
**EW4** - powdercoated light gray

### installation instructions

Position weight where desired.  
Turn tensioner into weight two turns.  
Insert cable into tip of tensioner;  
turn down by hand.

call for availability

3



### Arakawa Hanging Systems

2505 SE 11th Avenue, Suite 117  
Portland, Oregon 97202  
phone: 503.236.0440  
fax: 503.236.0427  
toll free: 888.272.5292

[www.arakawagrip.com](http://www.arakawagrip.com)

Copyright © 2005 Arakawa & Co., Ltd. All rights reserved.  
Arakawa products are covered by U.S. and foreign patents, issued and pending. Specification and price change privileges reserved.